

ZYRO MUSICAL BELL

| Instruction Sheet

Technical Characteristics

ZYRO BELL

The Zyro doorbell is an exciting way to welcome guests. Apart from its unique appearance and refined finish, the Zyro is feature-rich. The doorbell can play the tunes in sequence or you can choose a specific tune to be played, every time someone rings the bell. It also has volume control, play and pause feature to ensure that the doorbell sounds just the way you want it. The Zyro also has in-built 96 MB of storage that you can use to store the music of your choice. It is also equipped with flashing LEDs that blinks whenever a visitor rings the doorbell.

Technical Specifications

Features

1. Twenty one pre-recorded tunes
2. Inbuilt storage of 96 MB that has 34 tunes pre-installed.
3. USB cable provide to add custom songs/tunes into the inbuilt storage.
4. Software for customizing the tunes you want the doorbell to play
5. Play / Pause and Reverse / Forward functions
6. Volume control and shuffle function
7. Flashing LEDs
8. Unlike other doorbells that are always wall-mounted, the Zyro can be installed on the wall as well as the ceiling.

Installation

1. Connect the wires and fix the bottom plate into the ceiling or wall.
2. Match the mark and rotate the bell in the anti-clockwise direction until it matches the connector. (Refer back page)



Installation

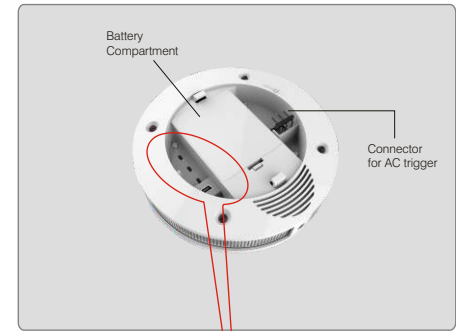
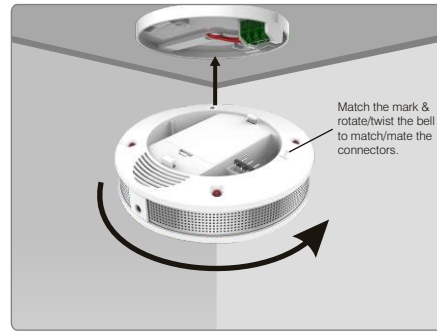
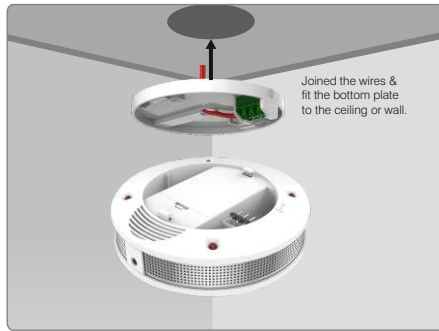

Wiring Diagram

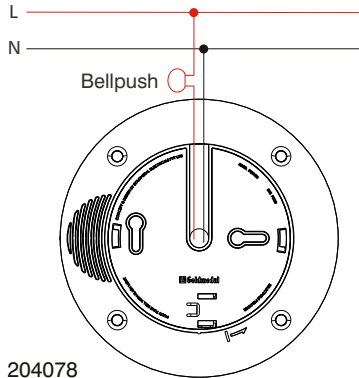

Dimensions (mm)

Side view shows overall dimensions & flush depth.

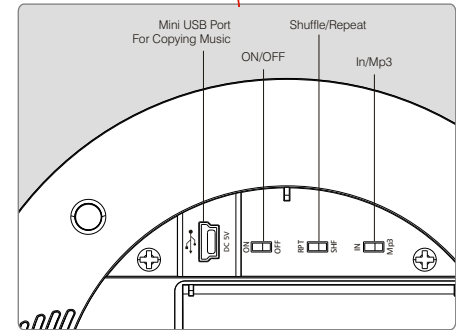
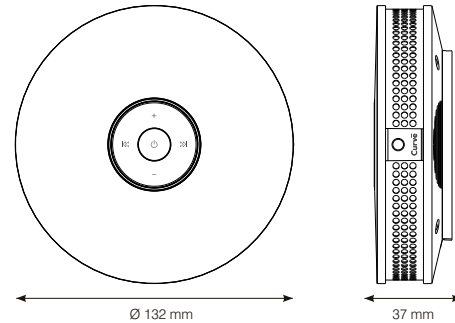

GOLDMEDAL ELECTRICALS PVT. LTD.

Bldg. No. 2, Shripal Industrial Estate, Valliv Road, Vasai East, Thane - 401208, Maharashtra, India.
For more details, email us at info@goldmedalindia.com www.goldmedalindia.com

© Copyright 2003 by Goldmedal Unless otherwise specified, the products illustrated in this Leaflet have been designed by Goldmedal and are covered by one or more international patents.

Customer Care Toll Free No.
1800 209 0234

